

CERTIFICATE OF LOCATION OF GOVERNMENT CORNER

NORTHEAST Corner of Section 16, Township 108 N., Range 43 W., 5th P.M.

STATE OF MINNESOTA, County of MURRAY

At the corner location shown on the sketch:

- On 6-13-86 found a 7"x7" CONCRETE MONUMENT WITH "X" ON TOP
DATE DOWN 0.2'
- left monument as found, lowered monument, removed monument (explain)
- On _____ placed a _____
DATE

SKETCH OF REFERENCE TIES

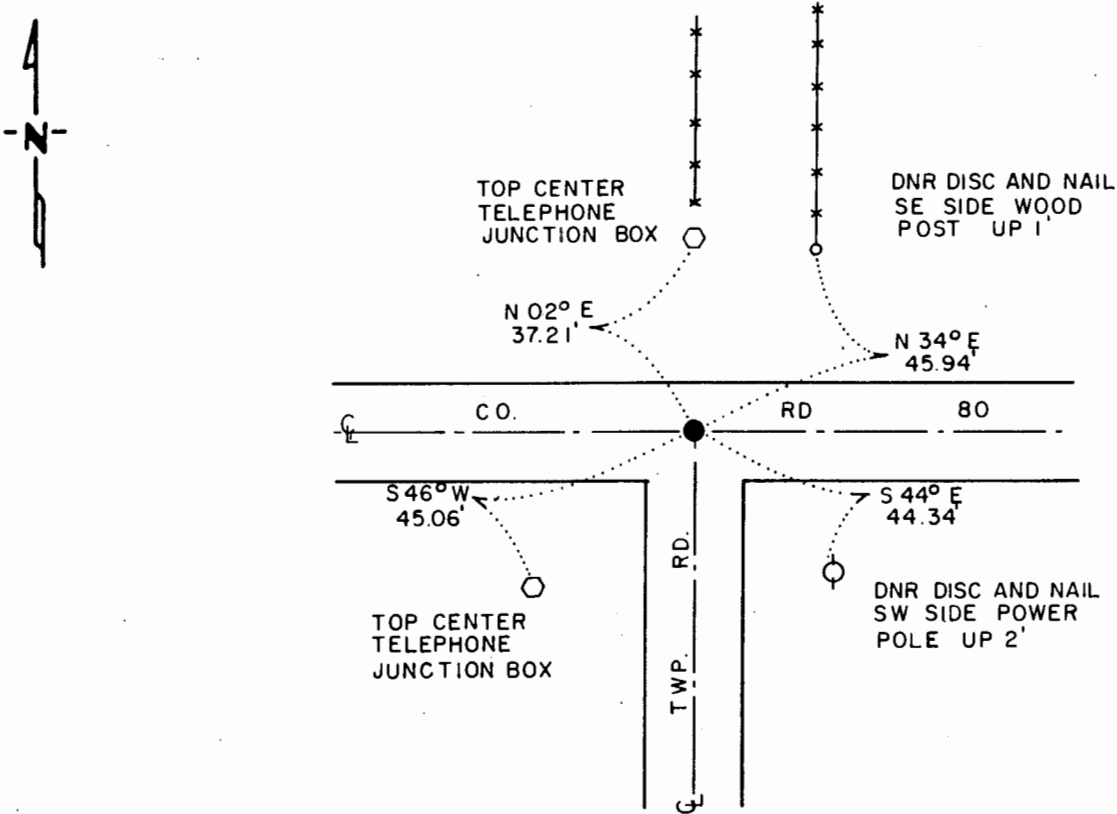

BEARINGS OBSERVED WITH COMPASS

Statement of evidence relative to this corner location is on back of page.

J. A. G. 7-1-86
FILE G-383

I hereby certify that this document and the data contained herein was prepared by me or under my direct supervision.

Lowell B. Pommersing Jr. 8-21-86
SIGNATURE DATE

Registration No. 17005

- Land Surveyor, Professional Engineer
- County Surveyor, County Engineer

OFFICE OF THE COUNTY RECORDER

County of _____

I hereby certify that this document was filed in the Co. Recorders office at _____ .M. on the _____ day of _____ A.D., 19__

County Recorder _____

By _____, Deputy

DOCUMENT NO. _____

This corner was originally established by the U. S. General Land Office survey in 1866. The government notes show corner marked with a wood post set in mound of earth with pits and trench dug around the mound.

In May 1986, the DNR Bureau of Engineering contacted the Murray County Offices of the Recorder and Highway Engineer for corner information.

The following information was obtained from the County Recorder's Office:
Surveyor's Record Book, on page 208, contains a survey by J. W. Woolstencroft, dated November 14, 1907. Survey states corner is a government corner, which measures 2614 ft. from the north quarter corner Section 16. No mention is made as to what was found or set at this corner.

Surveyor's Record Book, on page 207, contains a survey of Section 9 by J. W. Woolstencroft, dated November 21, 1908. Survey states all corners were established. Corner is shown 2633 ft. from the north quarter corner Section 16. No mention is made as to what was found or set at this corner.

The above information is also contained in the County Highway Engineer's Office.

The following information was obtained from the County Highway Engineer's Office:

Surveyor's Record Book contains a survey of Section 16 by J. W. Woolstencroft, dated November 21, 1908, and June 25, 1925. Survey states all corners were established except the southeast corner. Corner is shown:
2622 ft. from the north quarter corner Section 16
2649 ft. from the east quarter corner Section 16
No mention is made as to what was found or set at this corner.

Surveyor's Record Book contains ties to government corners in Section 9, by F. A. March, dated 1940. Corner is shown as a concrete stone with ties:
R. P. tack in corner fence post S.E. 47.5 ft.
R. P. tack in corner N. E. 36.7 ft.
R. P. tack in corner fence post S.W. 46.5 ft.

Surveyor's Record Book contains ties to government corners in Section 15, by F. A. March, dated 1940. Corner is shown as a concrete stone with ties:
R. P. tack in corner fence post S.W. 47.6 ft.
R. P. tack in corner fence post S.E. 47.4 ft.

In January 1957, the DNR Bureau of Engineering traversed to the area of the corner and located a position for this corner at the intersection of roads east-west and south, and fence line north. Set a railroad spike for the corner and took ties:

fence post, North 35.2 ft.
corner fence post, S.W. 46.5 ft.
5315.0 ft. from the northeast corner Section 9
2657.5 ft. from the east quarter corner Section 9

The following information was obtained from the County Highway Engineer's Office. Tie page of Surveyor's Record Book showing Section 15 has ties, dated 1957 by H. Suedbeck:

Bottle cap in power pole S.E. 44.4 ft.
Bottle cap in corner post North 34.5 ft.
Bottle cap in post South 34.8 ft.

A government corner tie sheet shows this corner as a concrete monument in 1982 with ties taken:

tack in power pole S.E. 43.92 ft.
tack in corner fence post N.E. 45.6 ft.
tack in fence post S.W. 53.54 ft.

In June 1986, the DNR Bureau of Engineering traversed to the area of the corner and found a 7" by 7" concrete monument with "X" on top down 0.2 ft. Searched for record ties, but found only the 1982 ties which were found to be in agreement with the found monument. Left monument as found and set a bridge spike on its east side. Concrete monument measures:

2609.30 ft. from the north quarter corner Section 16
5319.73 ft. from the northeast corner Section 9
on center line roads east-west and south, in line with fence north

Accept the concrete monument as the location of the corner.

Traverse information is available from the DNR Bureau of Engineering.